

# Application for Subdivision Consent

Comprised in C.F.R 806753  
Total Area : 9.7575 Ha  
ZONE : Residential Development Area  
Riccarton Park ODP  
Christchurch District Plan

NOTE : Areas and dimensions are subject to final survey  
THIS PLAN IS PREPARED FOR THE PURPOSE OF OBTAINING A RESOURCE CONSENT FROM COUNCIL TO THE DEVELOPMENT THE INFORMATION CONTAINED HEREON SHOULD NOT BE USED FOR OTHER PURPOSES

## Memorandum of Easements in Gross

NATURE	SERVIENT TENEMENT	SHOWN	GRANTEE:
Right to drain water in gross	Lot 164 Lot 163	A B	Christchurch City Council

## Schedule of Easement

NATURE	SERVIENT TENEMENT	SHOWN	DOMINANT TENEMENT
Right to Convey Electricity	Lot 166	Y	Section 1 SO 486359

Notes:

AREA SCHEDULE		
Residential Lots	Lots 6 - 51, 181 - 183	1.9135 Ha
Comprehensive Super Lots	Lots 151 - 160	2.7231 Ha
Recreation Reserve	Lot 161	0.3000 Ha
Utility Reserves	Lots 162-164, 166, 167	1.2542 Ha
Road to Vest	Lots 171 - 175	2.6021 Ha
Racecourse	Lots 1 and 2	0.9634 Ha
Utility Lots	Lots 178, 179	0.0012 Ha
<b>TOTAL</b>		<b>9.7575 Ha</b>

MINIMUM YIELD REQUIRED FROM SUPER LOTS

Lot 151	4 Lots
Lot 152	16 Lots
Lot 153	5 Lots
Lot 154	4 Lots
Lot 155	16 Lots
Lot 156	4 Lots
Lot 157	4 Lots
Lot 158	17 Lots
Lot 159	12 Lots
Lot 160	8 Lots
<b>TOTAL</b>	<b>90 Lots</b>

Lot Numbers 52 to 141 have been allocated to the Lots to be further subdivided from Lots 151 - 160.  
There are no Lots 3 - 5, 52 - 150, 165, 168 - 170, 176, 177 and 180 on this plan.

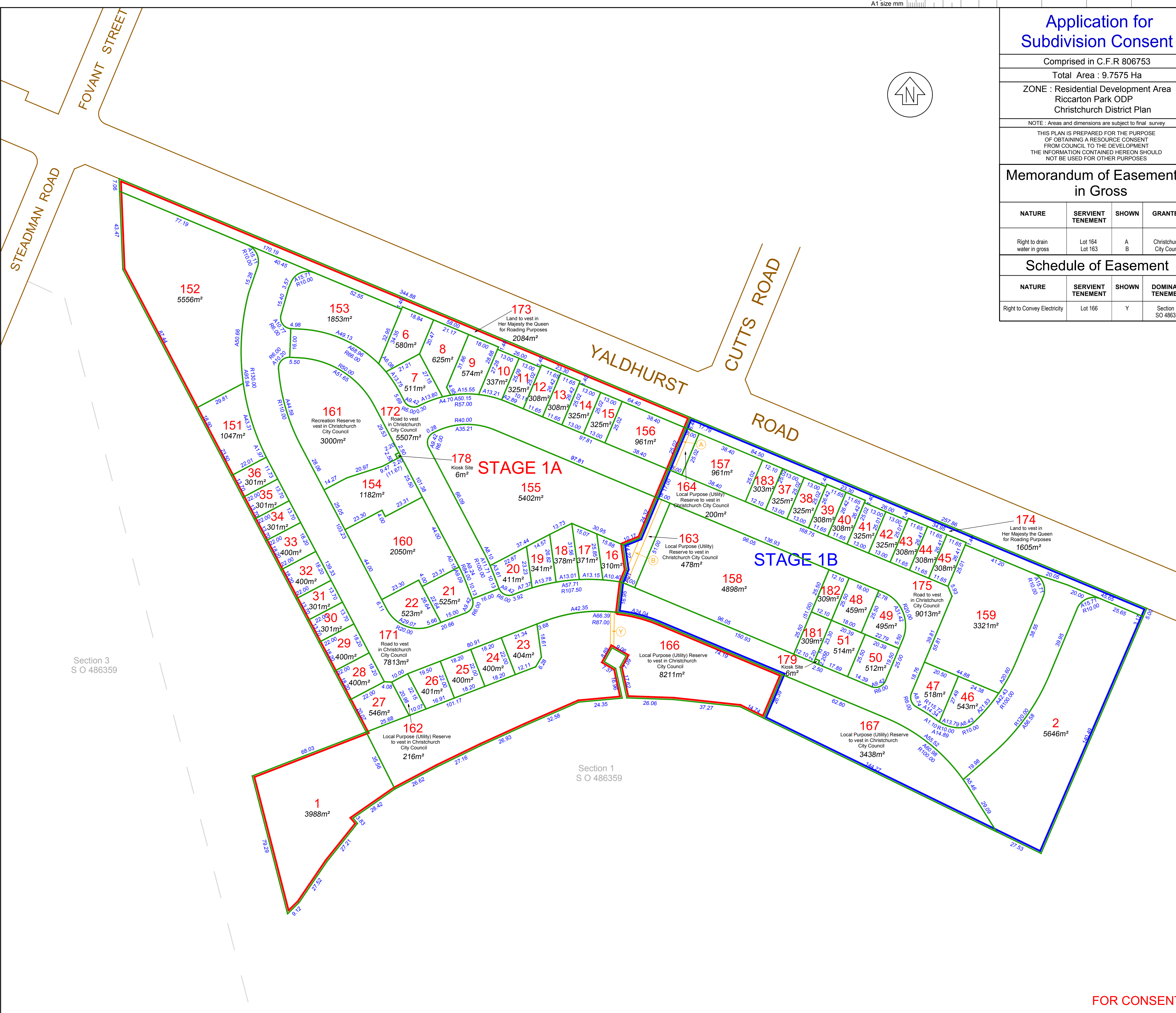

Rev.	Description	Drawn	Date
A	Add Lot 160 out of Lot 154	rks	17.07.2017
B	Add Stages 1A, 1B & Lot 167; Amend Lots 21, 22, 161	rks	21.08.2017
C	Add Kiosks Lots 178-9, Esmt Y; Change Reserve Purps	rks	28.09.2017
D	Redesign Lots 164, 164; add Lots 181 - 3	rks	10.11.2017

Name	Date	Surveyed:	Survey Date:
Designed: Jade McFarlane	15.06.2017	Richard Paulsen	December 2016
Drawn: Bob Greening	27.06.2017	Coord System:	NZGD 2000
Dr. Chk: Keith Mills	28.06.2017	Mt. Pleasant 2000	
Proj. Mgr: Keith Mills	-	Calibration: -	
Design Review	Date	Origin of Levels:	EHCH
-	-	Masonry Nail & Washer in kerb	
Approved	Date	148 Yaldhurst Road	
-	-	R.L. 31.287	
-	-	Datum: CCD	

**NGĀI TAHU Property**

Project Title  
**Riccarton Park - KARAMŪ - Development**  
Yaldhurst Road

Drawing Title  
**Stage 1 - Riccarton Park Development**  
Subdivision of Section 2 SO 486359

Scales  
1:1000 [A1] 1:2000 [A3]

Project No.	Set No.	Sht No.	Rev.
419748	C1	1	D

**Eliot Sinclair**  
surveyors | engineers | planners

FOR CONSENT